

NOTES:
 ALL DIMENSIONS MUST BE CHECKED ON SITE AND NOT SCALED FROM THIS DRAWING.

1. DOORS :-
 NEW INTERIOR FLUSH DOORS TO BE 35mm THK. HOLLOW CORE IDENTIFIED AS TYPE ①.
 44mm 1/2 HOUR FIRE CHECK DOOR TO KITCHENETTE ONLY IDENTIFIED AS TYPE ②.
 SELF CLOSING HINGES TO THE FOLLOWING DOORS, KITCHENETTE, MAIN ENTRANCE TO FEMALE /MALE TOILETS AND WAITING AREA.

2. WALLS :-
 ALL PARTITIONS ARE SHOWN APPROX. EXACT POSITION TO BE ESTABLISHED ON SITE.
 ALL NEW PARTITION WALLS TO BE METAL STUD WITH 12mm PLASTERBOARD TO BOTH SIDES. APPLY ONE THIN COAT OF GYPSUM PLASTER TO BOTH SURFACES.
 ALL WALLS TO CEILING HEIGHT.

3. PAINTWORK :- COLOUR WHITE
 ALL EXISTING WALLS TO TAKE ONE COAT OF EMULSION PAINT.
 NEW WALLS APPLY ONE COAT OF PRIMER/UNDERCOAT AND TWO COATS OF EMULSION PAINT.

4. FLOOR FINISH:-
 ALL EXISTING CARPET TILES TO BE REMOVED AND SURFACE MADE GOOD.
 VINYL FLOOR TILES TO LAID TO RECORD/FILING ROOM, PHOTOCOPIER MACHINE AREA, STORE, FEMALE /MALE TOILETS & WAITING AREA. NEW FLOOR CARPETS TO BE LAID TO THE REMAINING OFFICE AREA COLOUR TO BE DECIDED.

5. CEILING :-
 SUSPENDED CEILING FRAME TO REMAIN ALL CEILING LIGHTWEIGHT PANELS TO BE REPLACED WITH NEW.

GENERAL NOTES:-
 1. SPLASH BACK TILES TO SINK & WASH HAND BASINS COLOUR WHITE.
 2. ALL DEXION SHELVING TO CEILING HT UNLESS OTHERWISE STATED, SHELVING WIDTH TO BE 450mm TO BE INSTALLED IN THE RECORD/FILING ROOM AND CLEANERS ROOM.
 3. MECHANICAL EXTRACTOR FANS TO BE INSTALLED TO THE STORE, KITCHENETTE, TOILETS AND RECORD/ FILING ROOM.

Rev.	Drawn	Chkd.	Date	Description

H.M. Government of Gibraltar
 Technical Services Department
 Joshua Hassan House
 Secretary's Lane
 Gibraltar

Job Title

NEW HARBOURS UNITS 71 & 72

Drawing Title
NEW OFFICES FOR TREASURY SALARIES & WAGES SECTION - PROPOSED PLAN.

Drawn	M.CELECIA	Checked	-
Date	27-06-2012	Scale (at A1)	1 : 50
Drg. No.	183 - 386	Rev.	-

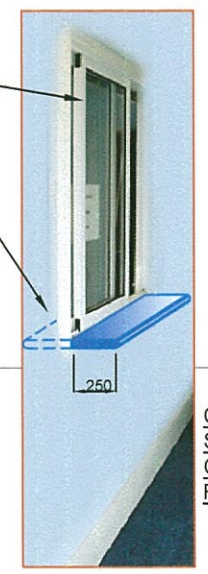

PROPOSED PLAN

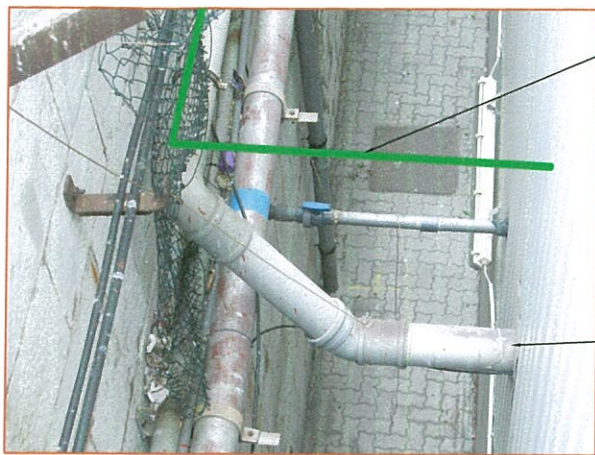

PIC 1.



PIC 2.



PIC 3.

NOTES:
ALL DIMENSIONS MUST BE CHECKED ON SITE AND NOT SCALED FROM THIS DRAWING.

1. DENOTES LOCATION WHERE PICTURES HAVE BEEN TAKEN.

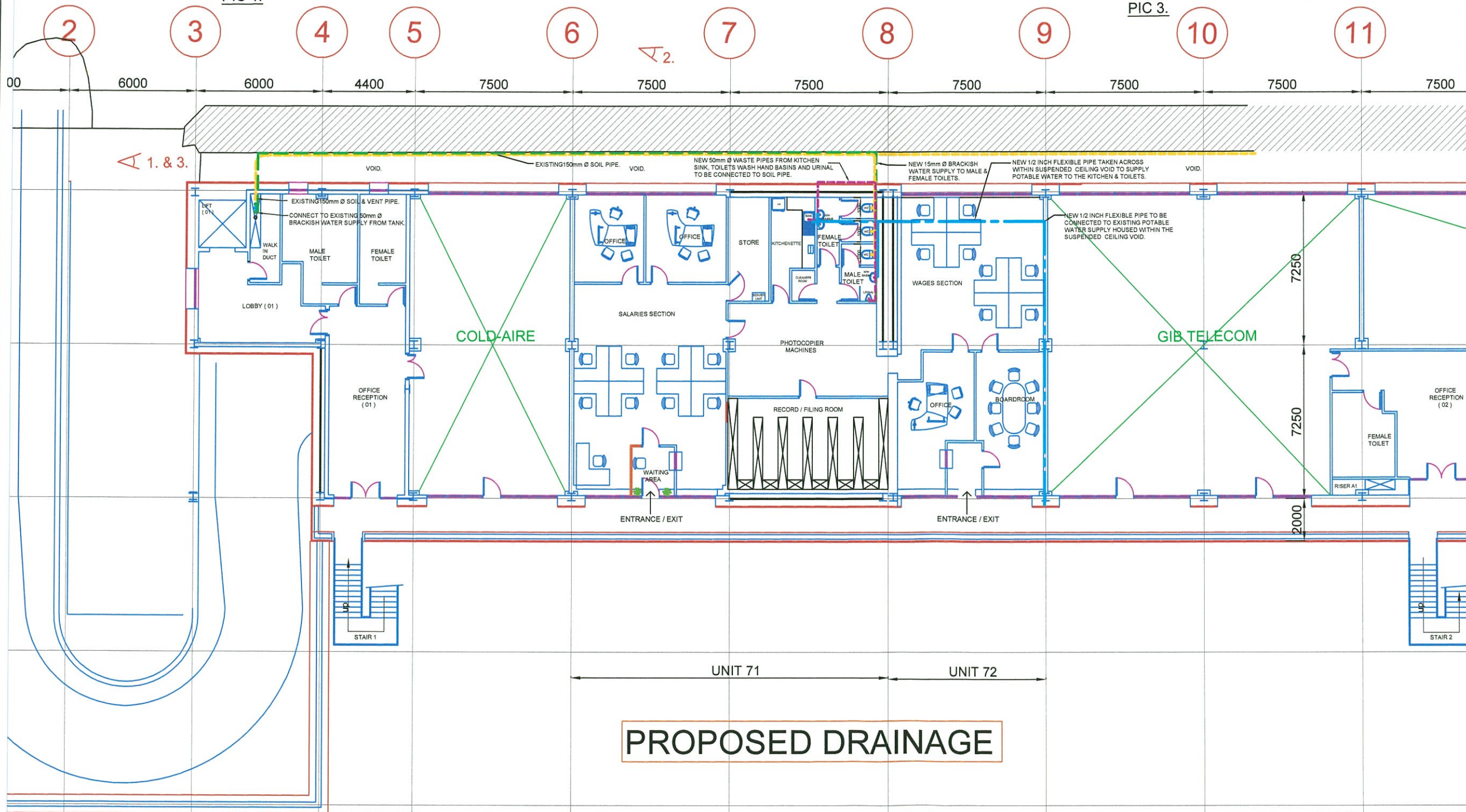

PROPOSED DRAINAGE

Rev.	Drawn	Chkd.	Date	Description

H.M. Government of Gibraltar
 Technical Services Department
 Joshua Hassan House
 Secretary's Lane
 Gibraltar

Job Title
**NEW HARBOURS
 UNITS 71 & 72**

Drawing Title
**NEW OFFICES FOR
 TREASURY SALARIES &
 WAGES SECTION -
 PROPOSED DRAINAGE.**

Drawn	M.CELECIA	Checked	-
Date	27-06-2012	Scale (at A1)	1 : 100

Drg. No. **183 - 387** Rev. -

NOTES:
ALL DIMENSIONS MUST BE CHECKED ON SITE AND NOT
SCALED FROM THIS DRAWING.

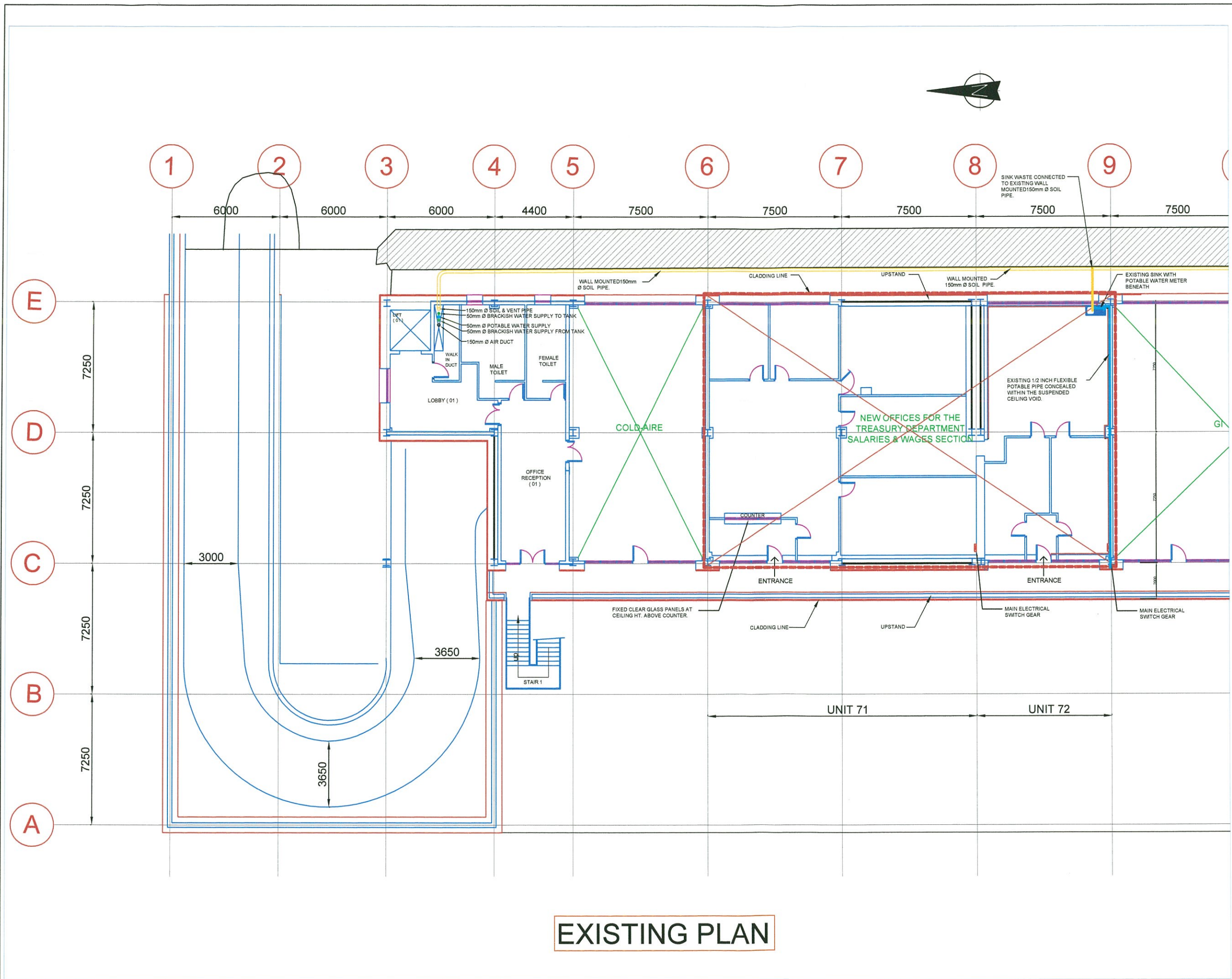

EXISTING PLAN

Rev.	Drawn	Chkd.	Date	Description
				H.M. Government of Gibraltar Technical Services Department Joshua Hassan House Secretary's Lane Gibraltar

Job Title
**NEW HARBOURS
UNITS 71 & 72**

Drawing Title
**NEW OFFICES FOR
TREASURY SALARIES
& WAGES SECTION -
EXISTING PLAN.**

Drawn M.CELECIA	Checked -
Date 27-06-2012	Scale (at A1) 1 : 100

Drg. No. 183 - 385	Rev. -
------------------------------	-----------